

Installation Guide

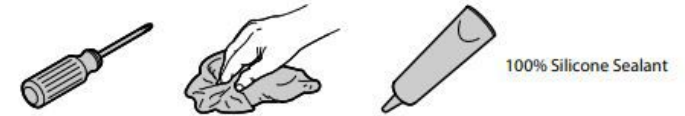

Undermount Sink

CAUTION: Risk of personal injury.

Product can break, chip or cause injury if handled carelessly. Handle with care.

IMPORTANT! Provide your countertop manufacturer with your bathroom sink model number. Countertop manufacturer should preinstall the anchors into the underside of the countertop. Use the anchors and fasteners provided by the countertop manufacturer and the clamps provided with your sink.

DO NOT use adhesives or adhesive sealants to install this sink. Observe all local plumbing and building codes.

Maintenance

For daily cleaning, a warm water-soaked sponge with mild soap followed by warm water rinse is recommended. Drying the sink afterwards with a soft cloth or towel will help to eliminate water spots and maintain shine.

Rinse thoroughly after each use. Most soaps and detergents contain chlorides that are harsh on porcelain. Chlorides are highly water soluble, so a thorough rinsing of your sink after each use, as well as a weekly cleaning, will keep your sink looking bright and shiny.

Towel dry after each use to prevent mineral deposits from building upon the surface of the sink. Water quality can affect the appearance of your sink. Towel drying and weekly cleaning will prevent discoloration or an unsightly film from developing on the finish.

1 Verify cabinet clearance.

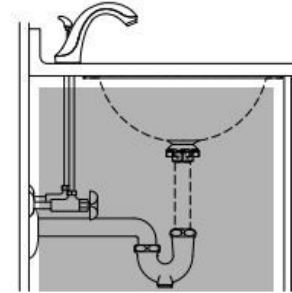

2 Clean the underside of the countertop and the rim of the sink.

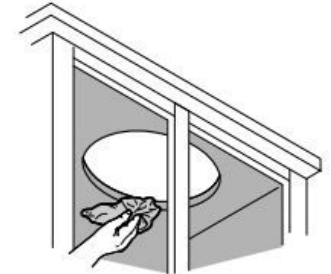

3 Loosely install the clips.

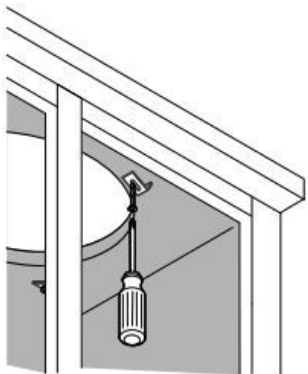

4 Generously apply 100% silicone sealant around the rim.



5 Position the sink under the opening. Hold the sink in place and rotate each clip over the rim. Evenly tighten the clips to secure.

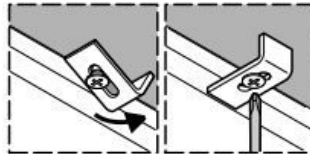

6 Immediately wipe away any excess sealant.



7 Complete the faucet and drain installations.



8 Run water into the sink and check all connections for leaks.

